

Maintenance

Periodic replacement of the high intensity lamps may be required. The replacement part number is 59-1600-00. Lamp replacement is accomplished by disconnecting the power cord, then removing the screw from the side cap. Slide out the side cap while being careful not to damage the lamps. Remove the bulb(s) that need to be replaced by gently rocking at the base, then pull out. Insert the new bulb(s) making sure that the new lamp surface is clean and free from fingerprints (may be carefully cleaned with glass cleaner). Fingerprints or other contaminants will cause localized heating and lamp failure. Reassemble the unit by inserting the bulbs and side cap making sure to seat the bulbs into the retainer clips at the base.

Some shrink tube materials "out-gas" during the shrink operation. This out-gassing may in time dull the reflective surface of the Focus-Lite™ reflectors, increasing the time to achieve full shrink. Users should monitor their process to determine how often the reflectors must be cleaned. Reflectors can be cleaned with a cotton swab and glass cleaner.

The Ground Fault Circuit Interrupt (GFCI) needs to be reset after the unit is unplugged or power is interrupted.

All Focus-Lite machines are covered by a one (1) year limited warranty (replacement of lamps not included.) See terms and conditions of sale for full warranty details.

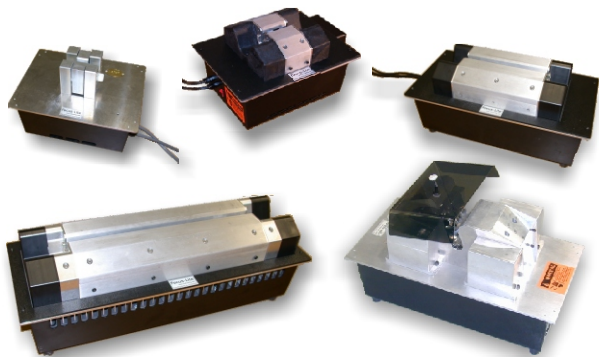

Focus^{Light}™

Heat Shrink Tube Processing Machine



FLG3 Instruction Booklet



For best results, cycle the Focus-Lite™ on-off. Leaving the Focus-Lite™ in a continuous on position may result in surfaces too hot to touch.

Overview

The Judco Focus-Lite™ G3 series heat shrink tube processing machine is a tool that will significantly streamline your heat shrink operation. High intensity light (contained in a semi-closed housing) is focused and reflected so that heat energy is applied simultaneously to all sides of the workpiece. This provides a uniform reduction in tube diameter and a very short cycle time compared to other methods. It fits comfortably on a single operator bench top workstation and can also be used in hand held operations. The standard model can accept shrink tube up to 5/8" in diameter and up to 1.375 in length.

Operation is simple. The unit plugs into a standard 120 VAC grounded outlet (NEMA 5-15). A foot-switch or trigger applies power to two high intensity lamps. The lamps reach optimum temperature within milliseconds while directing heat energy to all sides of the workpiece. For visual control, the operator can see the shrinking taking place through the glare shield.

The Focus-Lite™ G3 will shrink up to 1.375" length tube in three seconds or less. For bench top applications just mount the G3 onto the stand, set the timer and intensity control, then place the shrink tube into the "U" shaped opening while holding the wires. Depress the foot switch. For hand held operations such as a harness board, place the FLG3 opening over the shrink tube section and press the trigger switch. The actual time required for full shrink will depend on the shrink tube material and wall thickness.

Timer, Dimmer switch, and Foot Pedal Operation: for improved process control there is a timer and intensity control located on the back of the unit. Adjust the timer and intensity control for satisfactory results then document/record for repeatability. If you do not wish to use the timer, set the rotary switch to the "8" position. In this state, both starting and stopping of the heat cycle is controlled by the foot pedal or trigger switch. With the rotary switch in the 1-7 position, the foot pedal or trigger switch initiates the heat cycle, but the timer turns it off. The foot pedal or trigger must be pressed and released again to cycle. Your Focus-Lite is also equipped with a dimmer switch to adjust the bulb intensity. For high temperature operations the recommended setting is 7. All other materials should start at 4-5 and increase if necessary. Always attempt to shrink your material at the lowest setting which gives a satisfactory time result.

*shrink time based on polyolefin. Other materials may take longer.

Safety & Efficiency

The Ground Fault Circuit Interrupter and enclosed wiring make the Focus-Lite™ electrically safe. The Ground Fault Circuit Interrupter (GFCI) needs to be reset after the unit is unplugged or power is interrupted. The temperature of Focus-Lite parts is minimized by the cooling fan and the intermittent nature of power application.

Attaching the Glare Shield:

Align the 3 Tabs to the Focus-Lites slots and snap in the Glare Shield as shown.

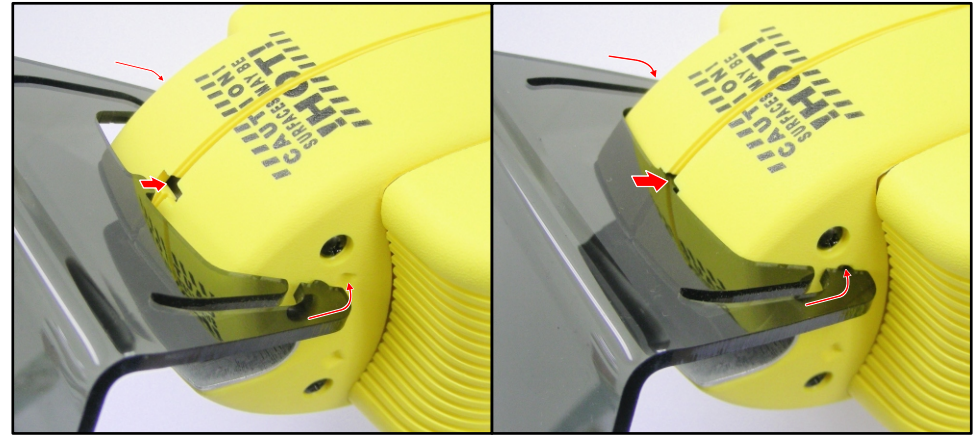

Attaching the Foot Switch Pedal:



Assembling the Bench Top Mount:

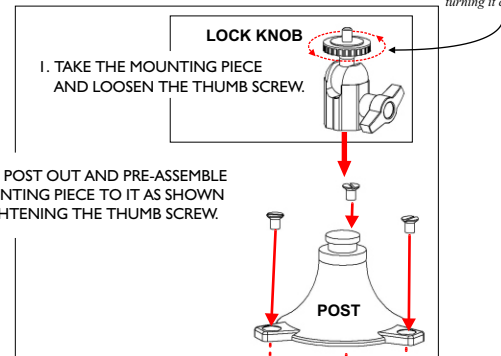
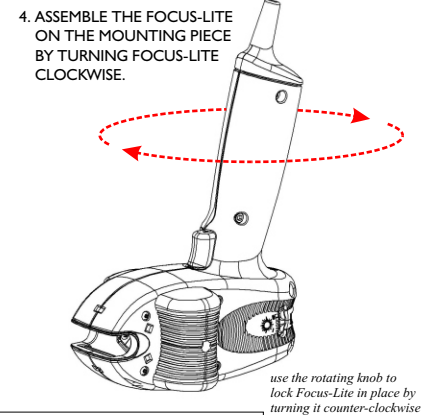

3. TAKE THE BASE OUT AND ASSEMBLE THE POST TO IT AS SHOWN WITH 3 SCREWS.

